

Subminiature Toggle Switches for SMT, waterproof

Specifications:

Contact rating:	max. 20 V AC/DC, 0,4 VA
Contact resistance:	< 20 mΩ
Insulation resistance:	> 1000 MΩ
Dielectric strength:	1000 V RMS at sea level
Operating temperature:	- 30 °C to + 85 °C
Electrical life:	50000 operations at full load
Contacts:	copper alloy, with gold plate over nickel plate
Terminals:	copper alloy, with tin plate over nickel plate
Protection:	IP 67
Material:	case and bushing: glass filled nylon 6/6 (UL 94 V-0) actuator: brass, chromium-plated switch support: brass, tin-plated
Mounting:	on pc-board – SMD

2

washable

Model: Switching function

SST 1 DT-R

on - on

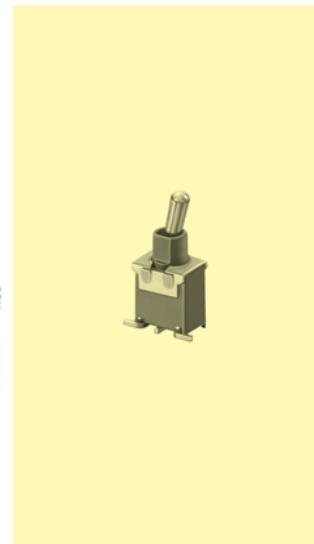
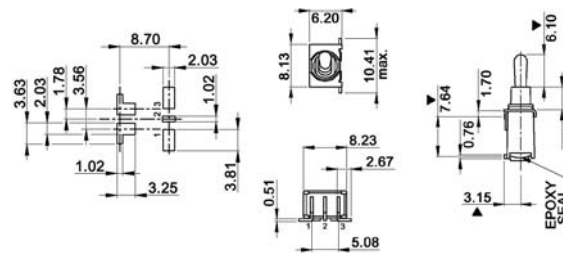

Packing: 500 pcs/reel

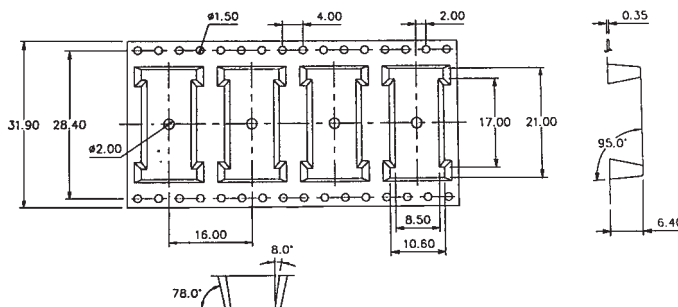

Subminiature Toggle Switches ESD proof, waterproof



Specifications:

Contact rating:	max. 20 V AC / DC, 0,4 VA
Contact resistance:	< 20 mΩ
Insulation resistance:	> 1000 MΩ
Dielectric strength:	1000 V, 50 Hz for the duration of 1 minute
Operating temperature:	- 30 °C to + 85 °C
Mechanical life:	minimum 50 000 operations
Contacts/Terminals:	copper alloy, gold-plated over nickel
Material:	case: nylon with glass fibre, meets UL 94 V-0, washable support: brass, tin-plated lever: brass, chromium-plated (...-ESD: PA, ESD resistance 6 kV)
Protection:	IP 67
Mounting:	on pc-board

Models: Switching functions: the closed contacts are opposite to the lever position.

washable

SPDT

TST 1 D (-ESD)	on	-	on
TST 1 E (-ESD)	on	off	on
TST 1 F (-ESD)	on	-	mom
TST 1 G (-ESD)	mom	off	mom
TST 1 H (-ESD)	on	off	mom

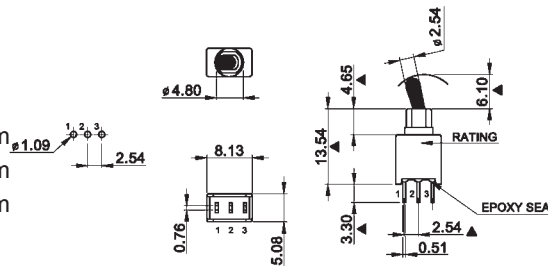

DPDT

TST 2 N (-ESD)	on	-	on
TST 2 R (-ESD)	on	-	mom
TST 2 P (-ESD)	on	off	on
TST 2 S (-ESD)	mom	off	mom
TST 2 T (-ESD)	on	off	mom
TST 2 PA (-ESD)	on	on	on
TST 2 SA (-ESD)	mom	on	mom
TST 2 TA (-ESD)	on	on	mom

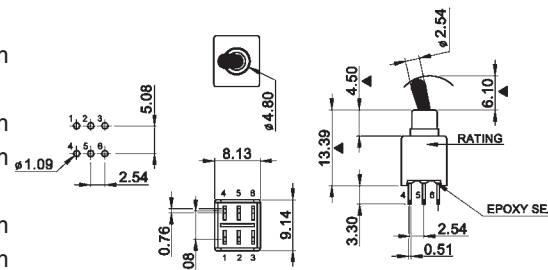



Subminiature Toggle Switches ESD proof, waterproof

Models: Switching functions: the closed contacts are opposite to the lever position.

SPDT

- TST 1 D – RA (-ESD) on – on
- TST 1 E – RA (-ESD) on off on
- TST 1 F – RA (-ESD) on – mom
- TST 1 G – RA (-ESD) mom off mom
- TST 1 H – RA (-ESD) on off mom

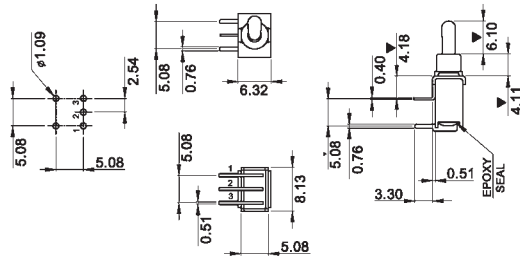

washable



DPDT

- TST 2 N – RA (-ESD) on – on
- TST 2 R – RA (-ESD) on – mom
- TST 2 P – RA (-ESD) on off on
- TST 2 S – RA (-ESD) mom off mom
- TST 2 T – RA (-ESD) on off mom
- TST 2 PA – RA (-ESD) on on on
- TST 2 SA – RA (-ESD) mom on mom
- TST 2 TA – RA (-ESD) on on mom

