



# Illuminated Pushbutton Switches

## Specifications:

Contact rating:	32 V DC, 100 mA, 1 VA
Contact resistance:	< 150 mΩ
Insulation resistance:	> 100 MΩ
Dielectric strength:	250 V, 50 Hz for the duration of 1 minute
Operating temperature:	-40 °C to +85 °C
Operating force:	4 N ± 1.2 N
Mechanical life:	minimum 25 000 operations
Material:	Contacts: stainless steel, silver plated Terminals: brass, gold plated Case: LCP, UL 94 V-0 Actuator: PC
Mounting:	on pc-board
Soldering conditions:	wave soldering, max. 5 s max. 260 °C, pre-heat max. 60 s max. 100 °C
Travel:	2.4 mm ± 0.3 mm

## Models: Switching function

TM 81 FW-RA off - mom

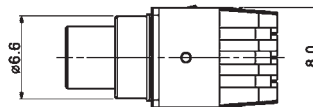
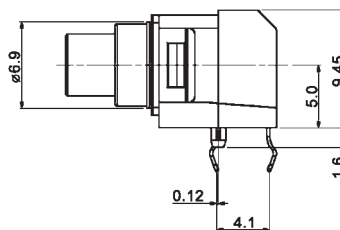
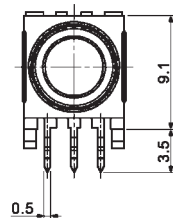
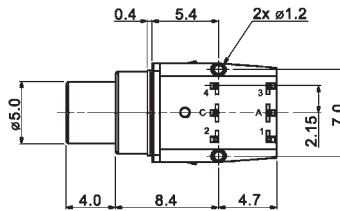

## P.C.B. Layout

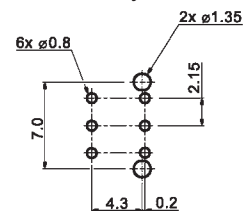

## Ordering Code:

TM 81 F  - RA

## LEDs:

- without LED
- W white       B blue
- R red           YG yellow/green
- Y yellow        RG red/green
- G green         BA blue/amber

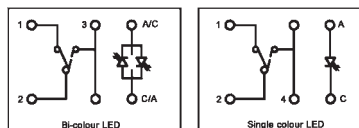

# Illuminated Pushbutton Switches

## Specifications:

Contact rating:	250 V AC, 3 A / 125 V AC, 3 A 30 V DC, 3 A
Contact resistance:	< 50 mΩ
Insulation resistance:	> 100 MΩ at 500 V DC
Dielectric strength:	1500 V, 50 Hz for the duration of 1 minute
Operating temperature:	- 25 °C to + 70 °C
Mechanical life:	minimum 30 000 operations
Contacts/Terminals:	solder tags or PC terminals, brass, silver-plated also available gold-plated, version B (see page 4)
Case material:	PA, black
Mounting:	single-hole mounting or on pc-board
Soldering conditions:	hand-soldering – max.: 30 W, 5 sec, 270 °C auto-soldering – max.: 3 sec, 245 °C ± 10 °C

## Models: Switching functions

D P D T

LP 2 SR. – PC on – mom  
LP 2 SN. – PC on – on

Illumination by **one** LED

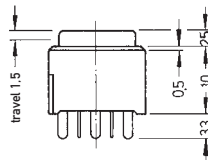
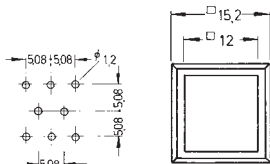

D P D T

LP 2 SR. on – mom  
LP 2 SN. on – on

Illumination by **one** LED

R (LED red)  
G (LED green)  
Y (LED yellow)

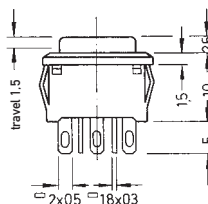
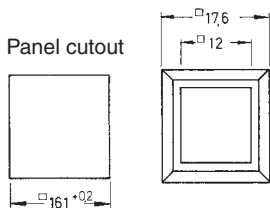

D P D T

LP 2 WR. – PC on – mom  
LP 2 WN. – PC on – on

Illumination by **two** LEDs

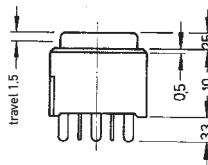
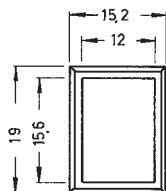

D P D T

LP 2 WR. on – mom  
LP 2 WN. on – on

Illumination by **two** LEDs

R (LED red)  
G (LED green)  
Y (LED yellow)

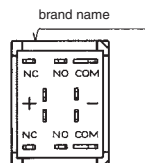
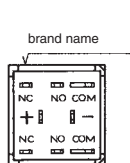
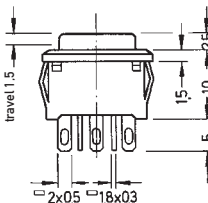
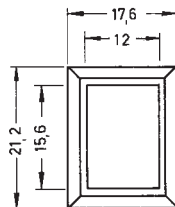

LP 2 .. R: I<sub>F</sub> = 30 mA; U<sub>F</sub> = 2,0 V  
LP 2 .. G: I<sub>F</sub> = 20 mA; U<sub>F</sub> = 1,95 V  
LP 2 .. Y: I<sub>F</sub> = 20 mA; U<sub>F</sub> = 1,9 V

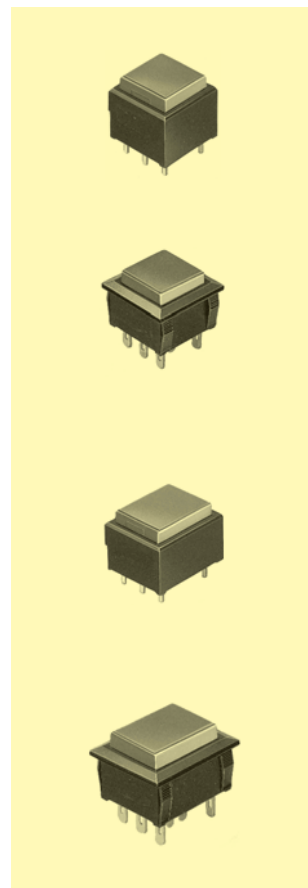



# Illuminated Pushbutton Switches

## Specifications:

Contact rating:	12 V DC, 100 mA
Contact resistance:	< 20 mΩ
Insulation resistance:	> 100 MΩ
Dielectric strength:	600 V, 50 Hz for the duration of 1 minute
Operating temperature:	-25 °C to +50 °C
Operating force:	180 gf ± 50 gf
Mechanical life:	minimum 500 000 operations
Material:	Contacts: Brass, Gold-plated Terminals: Phosphor-Bronze, Tin-plated Case: PA66 Cap, diffusor: PC
Mounting:	on pc-board
Soldering conditions:	LP 14...: IR-reflow-soldering, LP 14...-PC: wave soldering; max. 5 s max. 260 °C, pre-heat max. 60 s max. 100 °C
Travel:	Operating point 2.9 mm, total travel 4.3 mm
Individual Marking:	possible by polyester-film inlay, recommended size 12.8 mm x 12.8 mm x 0.1 mm

## Models: Switching functions

D P D T  
LP 14 CG RGBW-PC off – mom

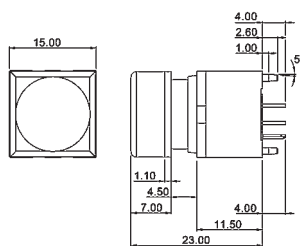

LP 14 CG RGBW off – mom

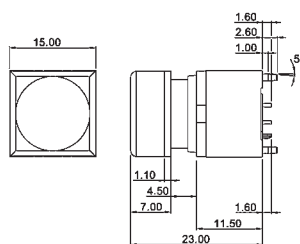

### pin-assignment

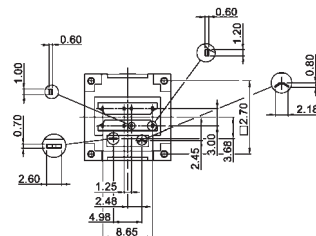
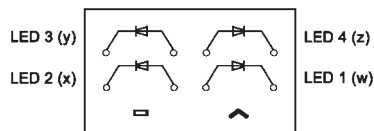

Ordering code: LP 14 CG □ □ □ □ – □

### LED colour:

- without LED
- W white
- Y yellow
- R red
- G green
- B blue

### Terminals:

- PC on pc-board (for auto-soldering)
- short terminals (THR)

**knitter-switch**



# Illuminated Pushbutton Switches

## Specifications:

Contact rating:	24 V DC, 50 mA
Contact resistance:	< 100 mΩ
Insulation resistance:	> 100 MΩ
Dielectric strength:	500 V, 50 Hz for the duration of 1 minute
Operating temperature:	-25 °C to +70 °C
Operating force:	1.6 N ± 0.2 N
Mechanical life:	minimum 500 000 operations
Material:	Contacts: stainless steel Terminals: brass, silver plated Case: PBT, UL 94 V-0, white Actuator: PC
Mounting:	on pc-board
Soldering conditions:	wave soldering, max. 5 s max. 260 °C, pre-heat max. 60 s max. 100 °C
Travel:	0.25 mm +0.2/-0.1 mm

## Models: Switching functions

LP 10 B 02GA11 off - mom

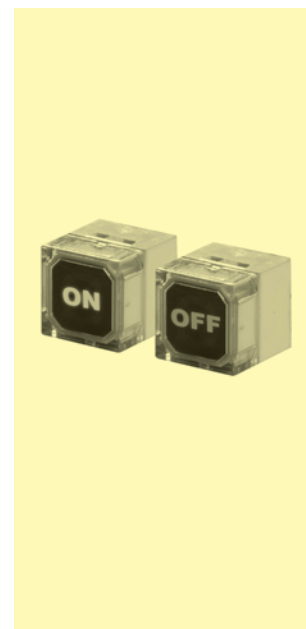
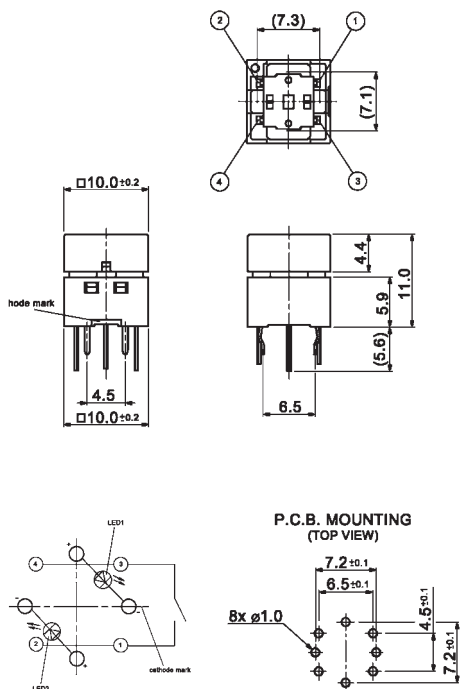

## Ordering Code:

LP 10   2  A1

### Contact material:

- silver
- gold

### Actuator:

- highly transparently
- white transparent

### LEDs:

- red/blue
- red/green

### Inlay:

- without inscription
- OFF (red) and ON (second colour)
- 切 (rot) und 入 (second colour)
- X (red) and O (second colour)

**knitter-switch**

**Distributor: Sider Electronic Industries Ltd.**  
**Tel: 852-23892522 Fax: 852-23574546**  
**Email: info@sider.com.hk URL: www.sider.com.hk**