



Illuminated Pushbutton Switches

Specifications:

Contact rating:	12 V DC, 100 mA
Contact resistance:	<20 mΩ
Insulation resistance:	>100 MΩ
Dielectric strength:	600V, 50Hz for the duration of 1 minute
Operating temperature:	-25°C to +50°C
Operating force:	180 gf ± 50 gf
Mechanical life:	minimum 500 000 operations
Material:	Contacts: Brass, Gold-plated Terminals: Phosphor-Bronze, Tin-plated Case: PA66 Cap, diffusor: PC
Mounting:	on pc-board
Soldering conditions:	LP 14...: IR-reflow-soldering, LP 14...-PC: wave soldering; max. 5 s max. 260 °C, pre-heat max. 60 s max. 100 °C
Travel:	Operating point 2.9 mm, total travel 4.3 mm
Individual Marking:	possible by polyester-film inlay, recommended size 12.8 mm x 12.8 mm x 0.1 mm

Models: Switching functions

D P D T
LP 14 CG RGBW-PC off – mom

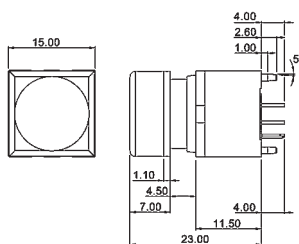

LP 14 CG RGBW off – mom

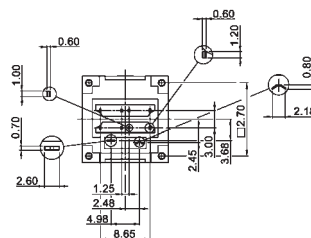
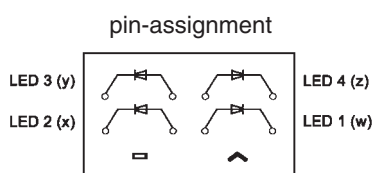
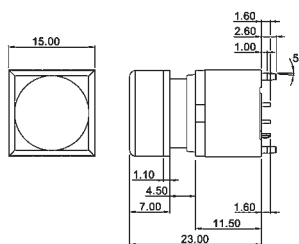

Ordering code: LP 14 CG -

- | | |
|--------------------------------------|---|
| LED colour: | Terminals: |
| <input type="checkbox"/> without LED | <input type="checkbox"/> -PC on pc-board (for auto-soldering) |
| <input type="checkbox"/> white | <input type="checkbox"/> short terminals (THR) |
| <input type="checkbox"/> yellow | |
| <input type="checkbox"/> red | |
| <input type="checkbox"/> green | |
| <input type="checkbox"/> blue | |

knitter-switch



Illuminated Pushbutton Switches

Specifications:

Contact rating:	250 V AC, 3 A / 125 V AC, 3 A 30 V DC, 3 A
Contact resistance:	< 50 mΩ
Insulation resistance:	> 100 MΩ at 500 V DC
Dielectric strength:	1500 V, 50 Hz for the duration of 1 minute
Operating temperature:	- 25° to + 70° C
Mechanical life:	minimum 30 000 operations
Contacts/Terminals:	solder tags or PC terminals, brass, silver-plated also available gold-plated, version B (see page 4)
Case material:	PA, black
Mounting:	single-hole mounting or on pc-board
Soldering conditions:	hand-soldering – max.: 30 W, 5 sec, 270° C auto-soldering – max.: 3 sec, 245° C ± 10° C

Models: Switching functions

D P D T
 LP 2 SR. – PC on – mom
 LP 2 SN. – PC on – on
 Illumination by **one** LED

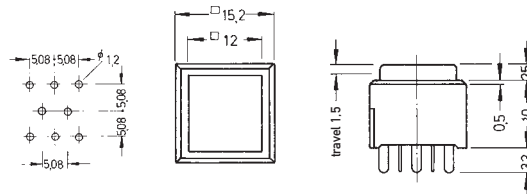

D P D T
 LP 2 SR. on – mom
 LP 2 SN. on – on
 Illumination by **one** LED
 R (LED red)
 G (LED green)
 Y (LED yellow)

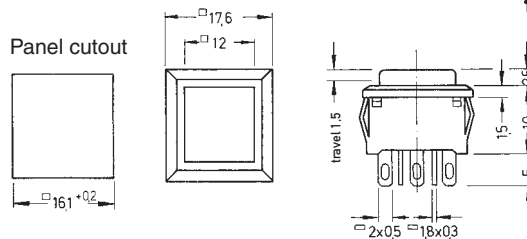

D P D T
 LP 2 WR. – PC on – mom
 LP 2 WN. – PC on – on
 Illumination by **two** LEDs

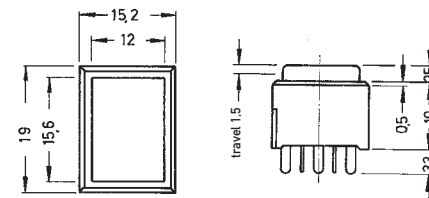

D P D T
 LP 2 WR. on – mom
 LP 2 WN. on – on
 Illumination by **two** LEDs
 R (LED red)
 G (LED green)
 Y (LED yellow)

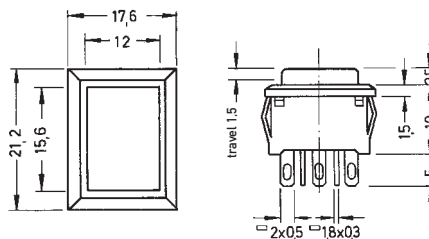

LP 2 .. R: I_F = 30 mA; U_F = 2,0 V
 LP 2 .. G: I_F = 20 mA; U_F = 1,95 V
 LP 2 .. Y: I_F = 20 mA; U_F = 1,9 V

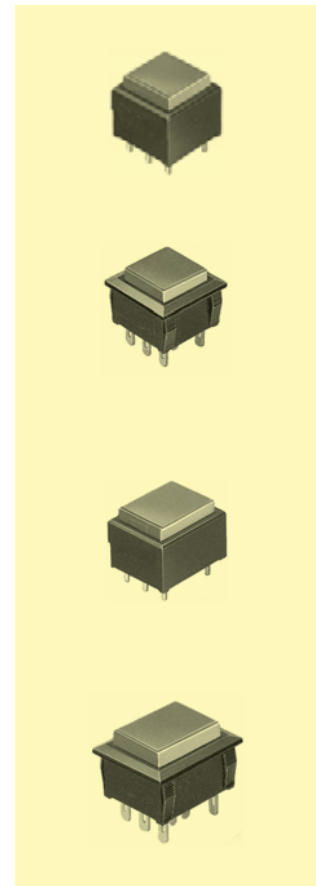
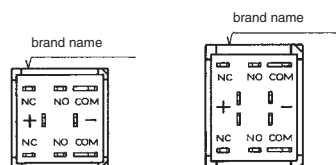

knitter-switch

Distributor: Sider Electronic Industries Ltd.
 Tel: 852-23892522 Fax: 852-23574546
 Email: info@sider.com.hk URL: www.sider.com.hk

Illuminated Pushbutton Switches for SMT



Specifications:

Contact rating:	12 V DC, 50 mA
Contact resistance:	< 100 mΩ
Insulation resistance:	> 100 MΩ
Dielectric strength:	250 V AC (50–60 Hz) for 1 minute
Operating temperature:	– 20° to + 70° C
Operating force:	1,6 N + 0,8/–0,3 N
Mechanical life:	minimum 50 000 operations
Stem/cover:	high-temp. PA 9T UL 94 V–0, white
Terminal:	brass, silver-plated
Contact:	stainless steel, silver-plated
Base:	high-temp. PA 9T UL 94 V–0, molded black

Models:

TSSL 3W □ □

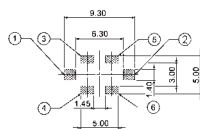

PCB Layout

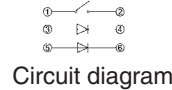
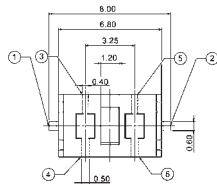

Circuit diagram

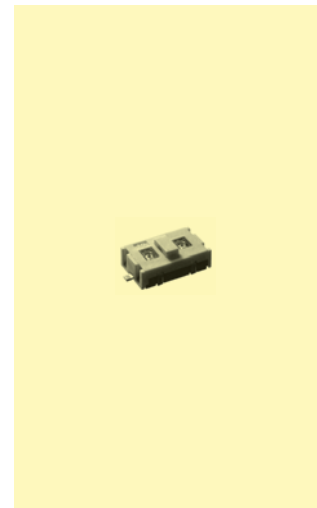

TSSL 3W □ □

- Left LED:**
- Ⓡ red
 - Ⓞ green
 - Ⓞ soft orange
 - Ⓜ white
 - Ⓟ blue

- Right LED:**
- Ⓡ red
 - Ⓞ green
 - Ⓞ soft orange
 - Ⓜ white
 - Ⓟ blue

Soldering conditions (reflow soldering)

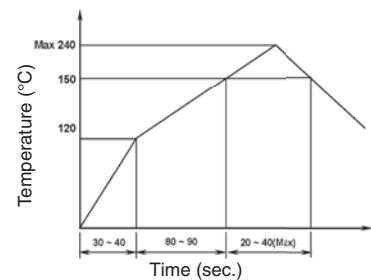

knitter-switch

Distributor: Sider Electronic Industries Ltd.
Tel: 852-23892522 Fax: 852-23574546
Email: info@sider.com.hk URL: www.sider.com.hk