



Anti-Vandal Pushbutton Switches waterproof, illuminated

Specifications:

Contact resistance:	< 50 mΩ
Insulation resistance:	> 1000 MΩ at 500 V DC
Dielectric strength:	2000 V RMS (50/60 Hz)
Operating temperature:	- 20 °C to + 55 °C
Electrical life:	50 000 cycles
Operating force:	5.5 N max.
Protection:	IP 67
Material:	Nut: nickel plated brass Base: PBT

Models:

MAV 02 LB22M3FDY6V
Rating: 250 V AC, 5 A

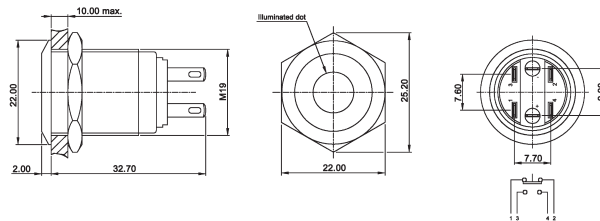

MAV 22 LB2M3FRBLO12V
Rating: 250 V AC, 5 A

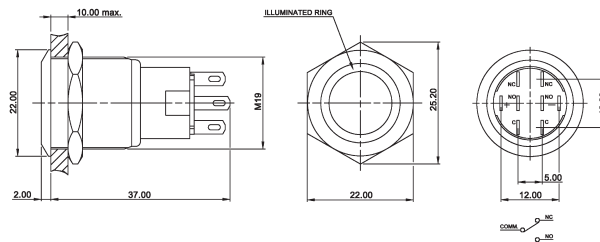

MAV 02 LB3M3RDO36V
Rating: 250 V AC, 3 A

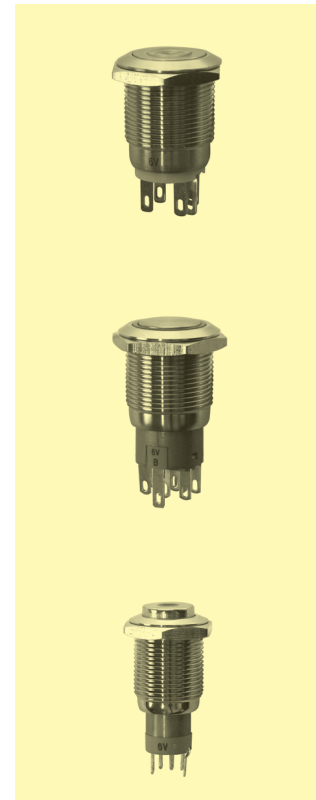
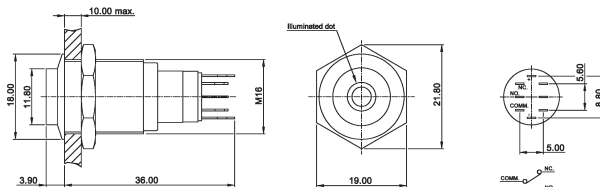

Ordering code:

Number of poles: <input type="checkbox"/> Single pole <input checked="" type="checkbox"/> Double pole		MAV <input type="checkbox"/> <input type="checkbox"/> <input type="checkbox"/> <input type="checkbox"/> <input type="checkbox"/> <input type="checkbox"/> <input type="checkbox"/> <input type="checkbox"/> <input type="checkbox"/> <input type="checkbox"/>		M3 <input type="checkbox"/> <input type="checkbox"/> <input type="checkbox"/> <input type="checkbox"/> <input type="checkbox"/> <input type="checkbox"/> <input type="checkbox"/> <input type="checkbox"/> <input type="checkbox"/>		LED voltage (AC/DC): <input type="checkbox"/> without LED <input checked="" type="checkbox"/> 6V 6 V, 15 mA <input checked="" type="checkbox"/> 12V 12 V, 15 mA <input checked="" type="checkbox"/> 24V 24 V, 15 mA <input checked="" type="checkbox"/> 36V 36 V, 5 mA <input checked="" type="checkbox"/> 110V 110 V, 5 mA <input checked="" type="checkbox"/> 220V 220 V, 5 mA	
Switching function: <input checked="" type="checkbox"/> on – mom <input checked="" type="checkbox"/> on – on		Button shape: <input checked="" type="checkbox"/> Recessed <input checked="" type="checkbox"/> Raised		LED color: <input type="checkbox"/> Without LED <input checked="" type="checkbox"/> Red <input checked="" type="checkbox"/> Green <input checked="" type="checkbox"/> Yellow <input checked="" type="checkbox"/> Orange <input checked="" type="checkbox"/> Blue <input checked="" type="checkbox"/> White		Contact arrangement: <input type="checkbox"/> Separate NO and NC contacts, short body (for B2, single pole) <input type="checkbox"/> Changeover contact (for B3) <input checked="" type="checkbox"/> Changeover contact, long body (for B2)	
Material of button/case: <input type="checkbox"/> Brass, nickel plated (for B3) <input checked="" type="checkbox"/> Brass, gold plated (for B3) <input checked="" type="checkbox"/> Stainless steel <input checked="" type="checkbox"/> Zinc alloy, nickel plated, black		Contact material: <input type="checkbox"/> Silver alloy <input checked="" type="checkbox"/> Gold over silver alloy		Lens style: <input type="checkbox"/> Without LED <input checked="" type="checkbox"/> Dot illumination <input checked="" type="checkbox"/> Ring illumination		knitter-switch	
Illumination: <input type="checkbox"/> Without <input checked="" type="checkbox"/> LED		Bushing size: <input checked="" type="checkbox"/> B2 M19 <input checked="" type="checkbox"/> B3 M16		Material of button/case: (repeated)		Material of button/case: (repeated)	

Distributor: Sider Electronic Industries Ltd.
Tel: 852-23892522 Fax: 852-23574546
Email: info@sider.com.hk URL: www.sider.com.hk